

Cutlass[®] Limited

12 Series Floor Plans

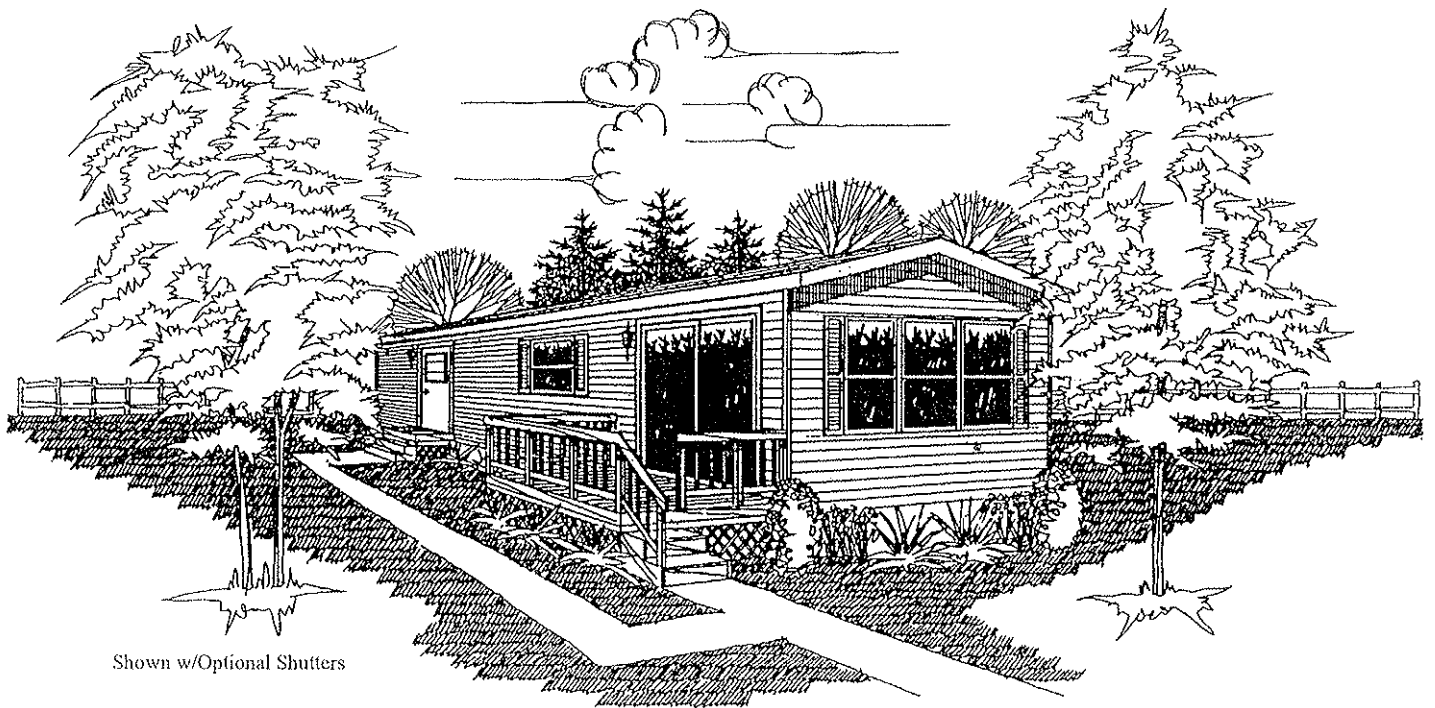

Shown w/Optional Shutters

Your local Cutlass[®] Limited dealer is:



SKYLINE[®]
BRINGING AMERICA HOME. BRINGING AMERICA FUN.

12 Series Cutlass® Limited

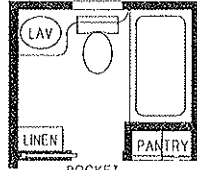

ALTERNATE BATH

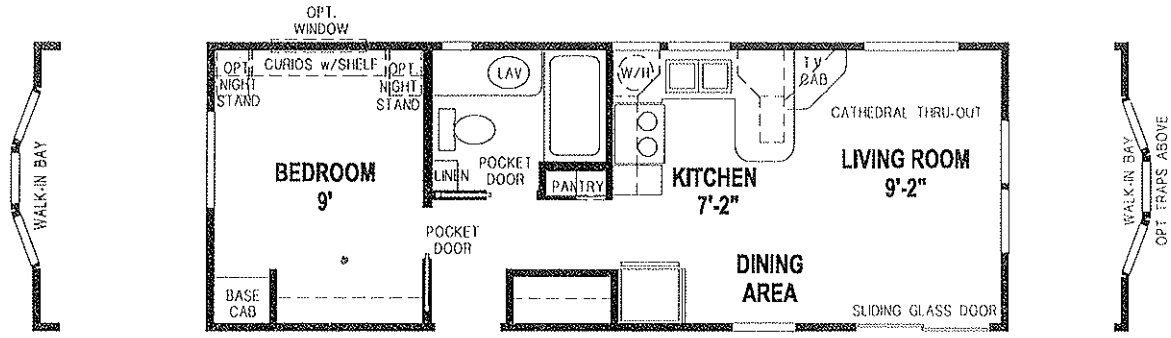

5210CT/32'812 1BEDROOM - CATHEDRAL THRU-OUT

OPT REAR WALK-IN BAY

OPT FRONT WALK-IN BAY

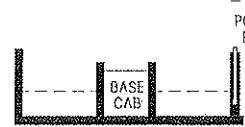

ALTERNATE WARDROBE



OPTION HALL STACK WASHER/DRYER



OPTION SIDE BAY

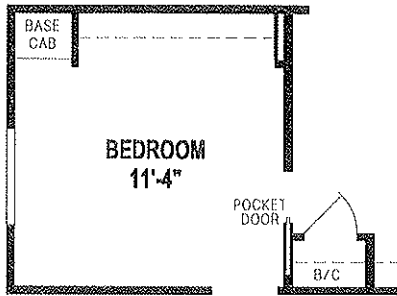

ALTERNATE ENTRY

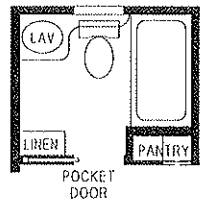

ALTERNATE BATH

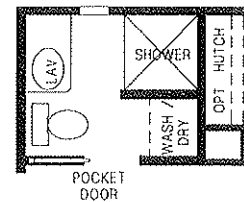

OPTION WASHER/DRYER BATH

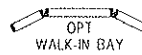

OPTION SIDE BAY

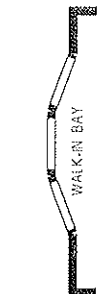

OPT REAR WALK-IN BAY

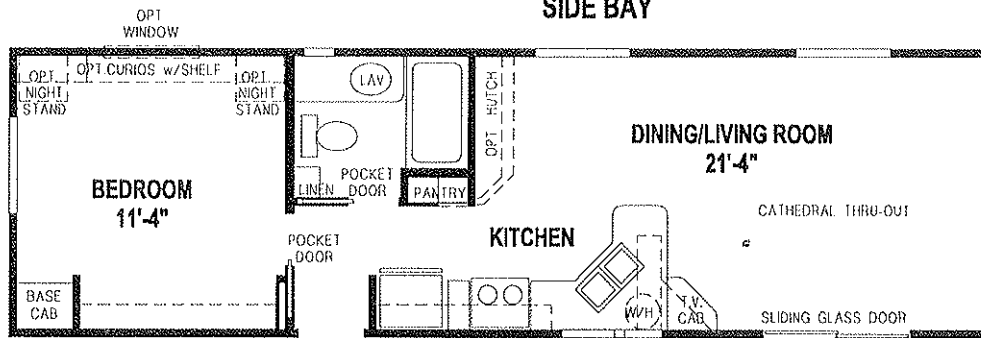

5209CT/4012 1BEDROOM - CATHEDRAL THRU-OUT



OPT FRONT WALK-IN BAY

FLOOR PLANS AVAILABLE FLIPPED SIDE-TO-SIDE

Cutlass® Limited

12 Series

Standard Features

LIVING AREAS

- Valance w/Mini-Blinds
- Large Cove at Ceiling
- Phone Jack
- TV Jack
- Chandelier Dining Light
- Vertical Blinds at Sliding Glass Door

KITCHEN

- Raised Panel Cabinet Doors w/Hardware & Residential Hidden Hinges
- Drawer Over Door Base Cabinet Construction
- Lined Overhead Cabinets
- Two Shelves in Base Cabinet
- Dual Handle Faucet at Sink
- 16 Cu. Ft. Double Door Frost Free Refrigerator
- 30" Gas Range w/Lighted Power Hood
- Valance w/Mini-Blinds
- Large Cove Above Cabinets

BATHROOMS

- Raised Panel Cabinet Doors w/Hardware & Residential Hidden Hinges
- Dual Handle Faucet
- Privacy Locks
- Towel Bar
- Power Vent Fan
- Round China Commodes

BEDROOMS

- Valance w/Mini-Blinds
- Ventilated Wire Shelving
- Phone Jack
- TV Jack

ADDITIONAL FEATURES

- Cathedral Ceiling Throughout
- Wire for Paddle Fan
- Shingle Roof w/Ridge Cap
- 25 Year Shingles
- Vinyl Lap Siding
- Textured Ceiling
- Detachable Hitch
- Carpet Pad w/Tack Strip
- Ceiling Air Diffusers
- Overhead Duct System
- 20 Gal. Water Heater
- ½" Jalousie Rear Door w/Drape
- Sliding Glass Door (Insulated)
- Keyed Alike Hardware
- Single Hung Vinyl Windows (Hud Only)
- Egress Windows in Bedrooms
- Insulation: R-38 Roof, R-33 Floor, R-11 Walls — HUD Only (R-19 Roof, R-11 Floor, R-11 Walls — ANSI) The Higher the "R-Value" the Greater the Insulation Power
- 7'-6" Sidewall Height
- 2 x 4 Sidewall, 16" O.C.
- 2 x 6 Floor Joists, 16" O.C.
- Copper Wiring
- Smoke Detector w/Battery Backup & False Alarm Control
- Exterior Receptacle w/GFI Breaker
- Electrical Breaker Box
- Exterior Light at All Exterior Doors
- Iron Gas Piping w/Shut-off Valves

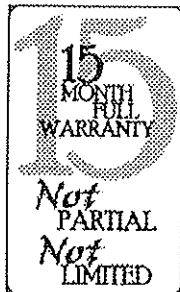

SKYLINE®

BRINGING AMERICA HOME. BRINGING AMERICA FUN.

Visit us at our web site at www.skylinecorp.com

*For your comfort and safety, Skyline home designs are approved and inspected for conformance to Federal standards.

* Dimensions stated to industry standards. Width and length dimensions are nominal and are not to be used for setup of home on site; consult selling retailers for exact specifications. Overall length does not include approximately four foot hitch. The square footage is approximate and based upon nominal exterior floor size. Room sizes are measured from floor ends and wall centers.

Because of progressive product improvement, all prices & specifications are subject to change without prior notice or obligation to Skyline Corporation.

Your Retailer, an independent contractor, who is not an agent of Skyline Corporation, is the party responsible for your purchase contract and any additions, deletions, alterations, or attachments made to or in your home.